

# Bath Plug + Waste



## Chrome waste + white rubber plug

- Durable, high quality finish.
- Chrome plated solid brass body and white rubber plug.
- Suits non-overflow baths and FlexiWaste kits.
- 40 mm hole – standard size for bath wastes.
- Connects to Australian Standard pipework.

## Order code

192007 Bath waste and rubber plug (no overflow)

## Product details

WASTE OUTLET Suits 40 mm waste holes.

**FIXING** Must be fitted by a licensed plumber. Warranty does not cover any fault caused by installation or part installation by an unlicensed person.

Please refer to the diagram for installation guidelines. It is essential that the waste is sealed correctly using silicone where shown.

**MATERIALS** Solid brass base with chrome finish. Rubber plug.

**CLEANING** Clean with soapy water. Do not use corrosive or abrasive cleaners.

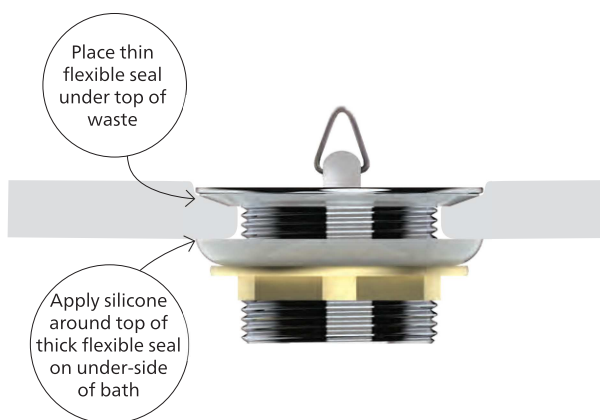

# SEIMA

kitchen + laundry + bathroom ware

[seima.com.au](http://seima.com.au)

## Please note

- All measurements are in millimetres.
- Use silicone sealant. Do not use epoxy type adhesives.
- Specifications may vary without notice as part of our continuous improvement practices.
- Clean with a damp cloth. Do not use abrasive cleaners, liquids or pastes.